

River Cours—

- N. 67½° E. 48
 - N. 71½° E. 24
 - N. 59½° E. 20
 - N. 80½° E. 18
 - N. 52° E. 38
 - N. 66° E. 14
 - N. 28° E. 80
 - N. 59½° E. 42
 - N. 86° E. 32
 - N. 62° E. 36
 - N. 74° E. 16
 - East 39
 - N. 88° E. 34
 - N. 16° E. 24
 - N. 26° W. 24
 - N. 49° W. 22
 - N. 23° W. 31
 - N. 3½° E. 14
 - N. 43° E. 52
 - N. 27½° E. 20
 - N. 1° W. 20
 - N. 39° W. 20
 - N. 26½° W. 20
 - N. 73½° E. 18
 - S. 79° E. 14
 - S. 75° E. 12
- ps. 732

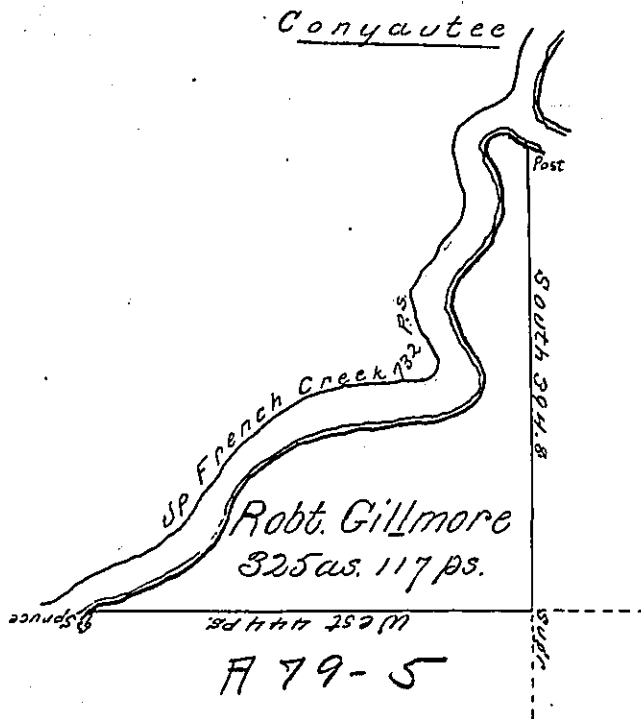

Benjamin Gibbs
68-189

Robert Blackwell

Situate on and adjoining the East Side of French Creek in Allegheny County containing 325 as. 117 ps. and allowance of Six pcent for Roads &c. Surveyed the 12th day of November 1794 In pursuance of a warrant dated the 13th. Day of April. 1792.

Wm. Power Dy Sr.
To Danl. Brodhead Esqr. }
Surveyor General }

IN TESTIMONY that the above is a copy of the original remaining on file in the Department of Internal Affairs of Pennsylvania, made conformably to an Act of Assembly approved the 16th day of February, 1833, I have hereunto set my Hand and caused the Seal of said Department to be affixed at Harrisburg, this third day of October 1899

James W. Latta
Secretary of Internal Affairs,

